



5 Trapper Grove

New Rossington, Doncaster, DN11 0GW

Guide Price £170,000

GUIDE PRICE £170,000 - £180,000

Nestled in the tranquil cul de sac of Trapper Grove, New Rossington, this modern semi-detached house presents an excellent opportunity for those seeking a comfortable and stylish home. With two well-proportioned bedrooms, including a luxurious en suite attached to the master, this property is designed for both convenience and comfort.

The inviting reception room offers a warm and welcoming space, perfect for entertaining guests or enjoying quiet evenings at home.

Outside, the landscaped rear garden provides a delightful retreat. Additionally, the property features parking for two vehicles, adding to the convenience of modern living.

With NO ONWARD CHAIN, this home is ready for you to move in and make it your own. Whether you are a first-time buyer, a small family, or looking to downsize, this property is sure to meet your needs. Don't miss the chance to view this charming home in a peaceful setting.

- Semi detached house
- Two double bedrooms
- Spacious lounge/dining room
- Luxury en suite to master and family bathroom
- Landscaped rear enclosed garden
- Quiet cul de sac location
- Off road parking for two vehicles
- Immaculately presented throughout
- Popular modern development
- No chain

Viewing

Please contact our Office on 01302 751616 if you wish to arrange a viewing appointment for this property or require further information.



Floor Plan

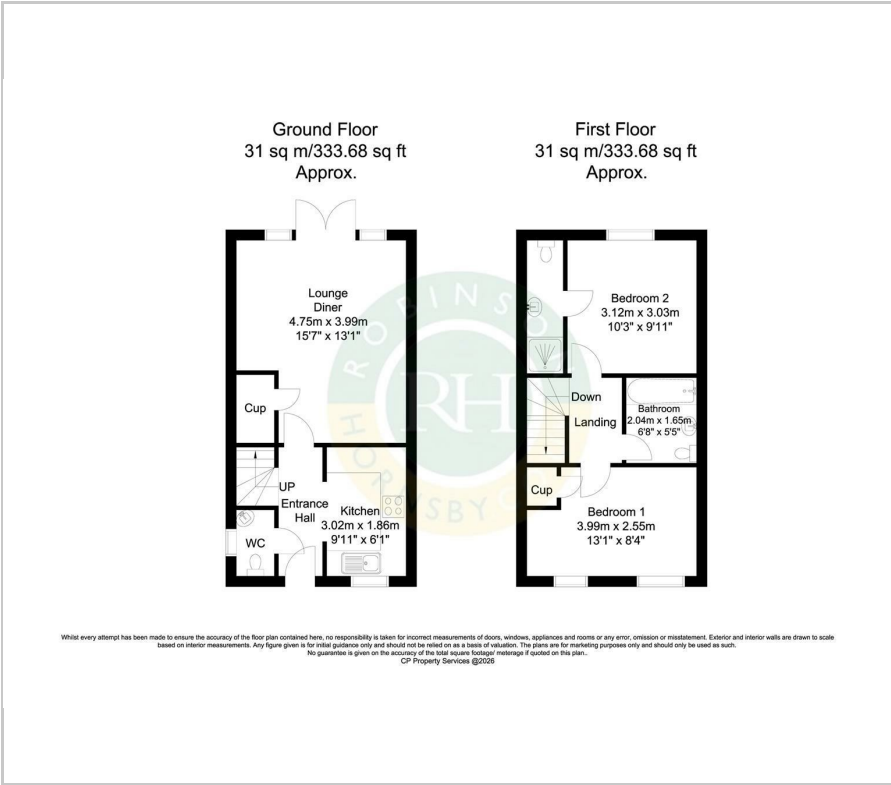

Area Map



Energy Efficiency Graph

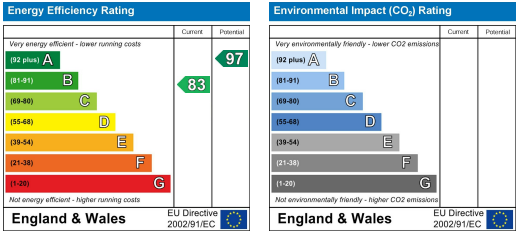

These particulars, whilst believed to be accurate are set out as a general outline only for guidance and do not constitute any part of an offer or contract. Intending purchasers should not rely on them as statements of representation of fact, but must satisfy themselves by inspection or otherwise as to their accuracy. No person in this firms employment has the authority to make or give any representation or warranty in respect of the property.